



Trailside

STRUCTURES, LLC

2026 RESIDENTIAL KENNEL CATALOGUE

ALL PRICES SUBJECT TO CHANGE WITHOUT NOTICE

WELCOME!

Your dog adores you and your family! Keep your dog safe and well cared for without worry. **Trailside Structures** has lots of residential kennels for you to choose from to make sure your choice enhances your property value and blends well with your other buildings.

Our main concern is giving you the options to keep your dog comfortable. We have everything you need to give your furry friend his own cozy house! From flooring that is safe for his little feet, doors that open just for him, and even the optional air conditioning and heating. We cater to all types of dog owners and we are sure we have a kennel that will fit your needs. Our craftsmanship and quality construction will provide years of performance and satisfaction. Let your dog know you love him and want to take good care of him – buy the best from quality made **Trailside Structures!**

TABLE OF CONTENTS

Standard Features	3
Residential Kennels	4 – 15
Fencing/Dividers/Panels.	16 – 19
Dog Doors and Accessories.	20 – 21
Doors & Windows.	22
Electrical & Lighting	22
Weathervanes & Cupolas	23
Feeders and Waterers	24
Air Quality Control	24 – 25
Washdown	25
Kennel Exteriors	26 – 27
Color Options	28 - 29
Contact Information	Back Cover



FLOORPLAN KEY

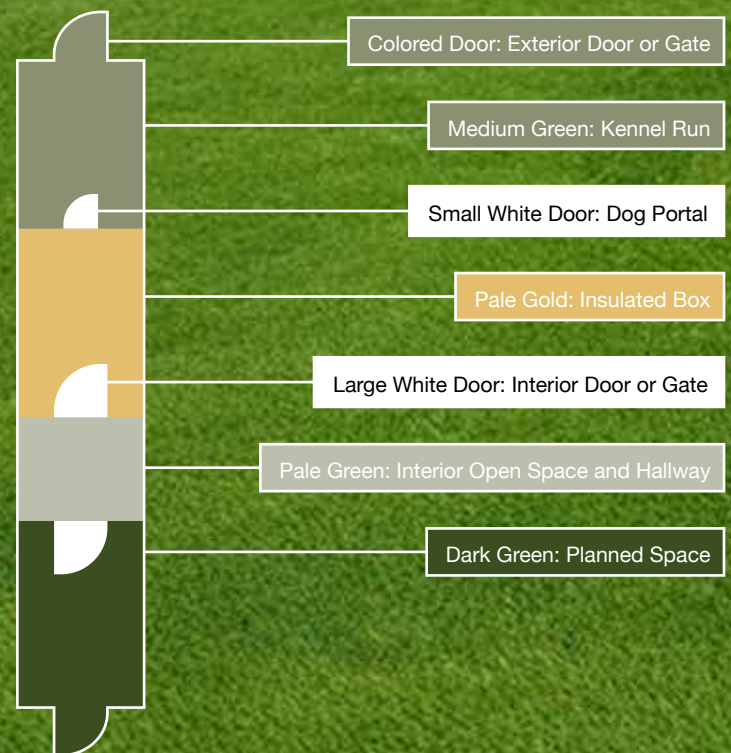



20" Plexiglass Dog Door(s)



R-11 Insulation



18" x 23" Window(s)



Spray Foam Insulated Floor



5/8" LP Flooring with 10-Year Warranty



30 Year Architectural Shingles



Runs Have Composite Decking



Elite Models Also Include:
18" x 27" Window(s)
Wide Trim Package
Larger & Wider Overhangs
Steeper Roof Pitch

STANDARD FEATURES

At Trailside Structures, we are dedicated to helping you provide the best possible housing for your dogs and puppies. We understand the commitment required to nurture healthy and happy canines, and we have designed our dog kennels with efficiency, safety, and the overall health of your pets in mind.



8 X 20

ELITE SHED & KENNEL COMBO

Shown With Optional Elite Gable Vents And Z-Shutters.



9' 5"
x
6' 11"

3' 6"
x
7'

6'
x
6' 7"

- Gray LP Smartside Siding
- White Trim
- Charcoal Shingles
- Black Doors

8 X 16

ELITE DOUBLE KENNEL

- Gray LP Smartside Siding
- Dark Gray Trim
- Weatherwood Shingles
- White Door

Shown With Optional Elite Gable Vents.



8 X 12

ELITE SINGLE SHED STYLE KENNEL

- LP Smartside
- Chestnut Urethane Stain
- White Trim
- Charcoal Shingles

Shown With Transom Dormer.





8 X 12

ELITE SINGLE KENNEL

- Board & Batten Siding
- Cedar Stain
- Forest Green Shingles
- Hunter Green Door

Shown With Optional Elite Gable Vents, Vinyl Posts On Run, And 11-Lite Door.

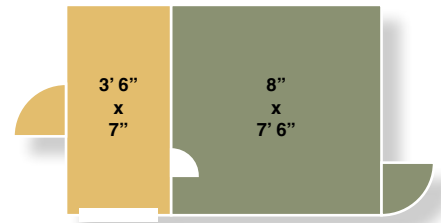

8 X 10

ELITE SINGLE KENNEL

- Navaho LP Smartside Siding
- Buckskin Trim
- Walnut Brown Shingles

Shown With Optional 9-Lite Door, Octagon Windows, Slat Shutters, Interior Chain Link Door, Elite Gable Vents & Vinyl Post Covers.

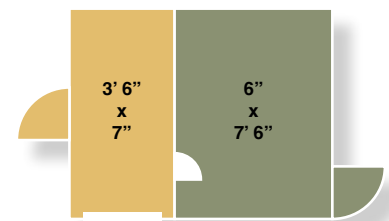

10 X 24

TRADITIONAL SHED & KENNEL COMBO

- Buckskin LP Smartside Siding
- Chestnut Trim
- Walnut Brown Shingles

Also Available In 10 X 20 And 10 X 18.
These Sizes Reduce The Shed Portion,
Not The Kennel.

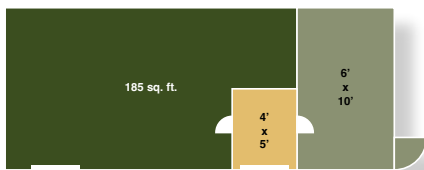

8 X 16

TRADITIONAL DOUBLE KENNEL

- Light Gray LP Smartside Siding
- Dark Gray Trim

Shown With Optional Pewter Gray
Metal Roof.

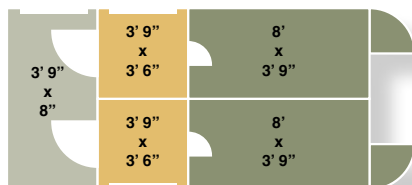



8 X 14

TRADITIONAL DOUBLE KENNEL

- Black Fox LP Smartside Siding
- Summit Gray Trim
- Charcoal Metal

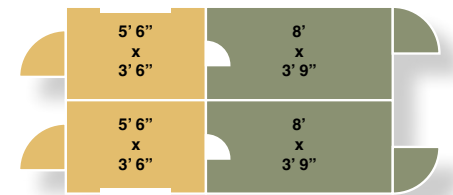

8 X 14

TRADITIONAL SINGLE KENNEL WITH FEED ROOM

- Board & Batten Siding
- Walnut Brown Shingles
- Chestnut Painted Door

Shown With Optional Vent, 11-Lite Door And Feed Room.

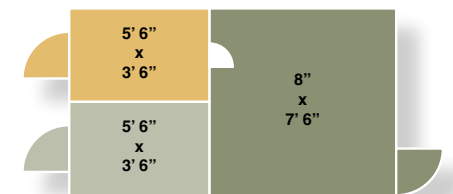

8 X 14

TRADITIONAL SINGLE KENNEL

- Clay LP Smartside Siding
- Black Trim
- Black Metal Roof
- Clay Door

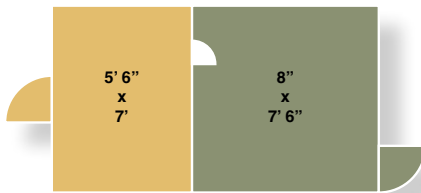

8 X 12

TRADITIONAL SINGLE KENNEL

- Red LP Smartside Siding
- Navajo White Trim
- Walnut Brown Shingles

Shown With Optional 11-Lite Arch Door.

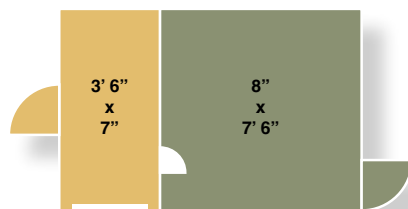



8 X 10

TRADITIONAL SINGLE KENNEL

- White LP Smartside Siding
- Black Trim
- Charcoal Shingles

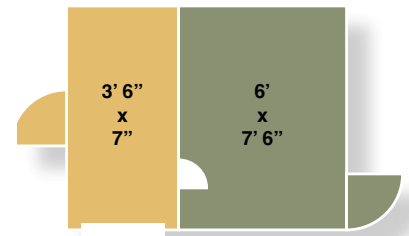

6 X 10

TRADITIONAL SINGLE KENNEL

- Tan LP Smartside Siding
- Red Trim
- Red Metal Roof

Shown With Optional Metal Roof.



6 X 8

TRADITIONAL SINGLE KENNEL

- Board & Batten Siding
- Natural Stain
- Walnut Brown Shingles
- Chestnut Color Door

Shown With Optional 9-Lite Door.

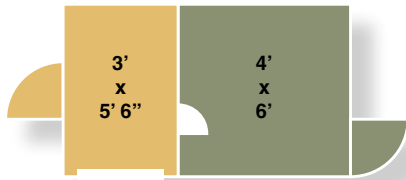

4 X 8

TRADITIONAL SINGLE KENNEL

- Lite Gray LP Smartside Siding
- White Trim
- Weatherwood Shingles





9 X 12

THREE RUN KENNEL

- Radiant Floor Heat
- Wash Down System
- Whelping Nest
- Light Gray Vinyl Siding
- Black Trim
- Black Shingles

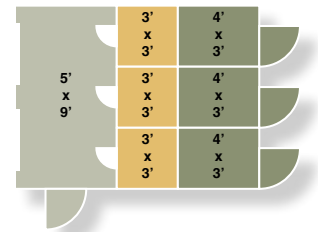

8 X 18

SHED & SINGLE KENNEL COMBO

- Vinyl Siding
- Feeder Bowl System
- A/C Unit
- Tan Siding
- White Trim
- Bronze Roof

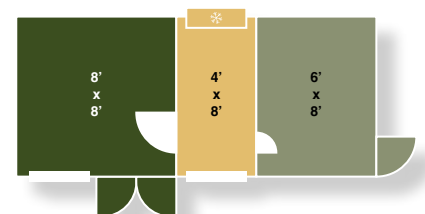



CUSTOM FEATURES



WELDED 2" X 4" WIRE KENNEL PANELS

Durable Construction: Made from 14 Ga galvanized tubing. Perimeter tubing is 1.315 O.C. Welded wire is spaced at 2"x 4" intervals with hot-dipped galvanized wire. All welds are sprayed with cold galvanized paint. Very durable if properly maintained.

Maintenance: Conduct regular inspections of the welded wire mesh and address any signs of damage or wear promptly. Applying rust-resistant paint or coatings as needed can help protect the mesh from the elements

Doors: 24" doors swing 90 degrees both in and out for easy access, equipped with welded on hinges, and bolt on butterfly latches.

Custom Sizing: Panels can be tailored to fit any space or enclosure size. Call for help with measuring or any questions.

Dog Bowls: Choose from several options and have your panel built to accommodate feeding and watering



WELDED 2" X 2" WIRE KENNEL PANELS

Durable Construction: Made from 14 Ga galvanized tubing. Perimeter tubing is 1.315 O.C. Welded wire is spaced at 2"x 4" intervals with hot-dipped galvanized wire. All welds are sprayed with cold galvanized paint. Very durable if properly maintained.

Maintenance: Conduct regular inspections of the welded wire mesh and address any signs of damage or wear promptly. Applying rust-resistant paint or coatings as needed can help protect the mesh from the elements

Doors: 24" doors swing 90 degrees both in and out for easy access, equipped with welded on hinges, and bolt on butterfly latches.

Custom Sizing: Panels can be tailored to fit any space or enclosure size. Call for help with measuring or any questions.

Dog Bowls: Choose from several options and have your panel built to accommodate feeding and watering

Perfect Fit: Our fencing panels are fully customized to your needs. To ensure the perfect fit, we recommend calling to discuss options and measurements.

We offer honest advice based on our experience and customer feedback, with no pressure or unnecessary upselling.



CHAIN-LINK KENNEL FENCING PANELS

Durable Construction: Made from 1.315in, 16 Ga galvanized tubing with .065 thickness. Standard Chain-link is made 11.5, 2.25" mesh with two coats of paint. First coat is cold galvanized paint with a top coat of metallic silver. For large aggressive dogs we recommend upgrading to our 9Ga. mesh.

Maintenance: Low maintenance

Doors: 24" doors swing 90 degrees both in and out for easy access, equipped with welded on hinges, and bolt on butterfly latches.

Custom Sizing: Panels can be tailored to fit any space or enclosure size. Call for help with measuring or any questions.

Dog Bowls: Choose from several options and have your panel built to accommodate feeding and watering

Upgraded Vinyl Coated Chain-Link Fencing



NORLOCK® KENNEL DIVIDERS/PANELS

NorLock by Trusscore divider panels are the perfect solution for creating strong, low maintenance partitions in dog kennels.

Designed to handle heavy use, these durable planks are easy to clean, abuse-resistant, and can even support items fastened directly to them.

Superior Strength: Built to handle heavy-duty use and withstand impact. Able to structurally support heavy items directly affixed

Easy to Clean: Non-porous, smooth surface makes cleaning quick and simple.

Low Maintenance: Resistant to wear and tear, requiring minimal upkeep. UV stabilizers prevent discoloring and cracking

Heavy-Duty: Engineered to withstand demanding environments like dog kennels. No external support necessary.

Versatile: Openings can be cut directly into NorLock

Colors: White or Gray

Environmentally Sustainable:
100% recyclable

Compare to the Standard with Vinyl Siding:
4' High Glassboard On Run Walls



Norlock Interlocking Panels Shown In White



Norlock Interlocking Panels Shown In Gray



Norlock Interlocking Panels Shown In White

DOG DOORS

SOFT CLOSE CANINE DOG DOOR

with Dual Swing Hinges



Easiest door for dogs to learn how to use! Both directions just need a nudge.

Ideal for boarding kennels, rescues and hospitals.

Durable: Built heavy duty.

Noise Level: Lower stress with a quiet closing door.

Warranty: 2 year warranty and all parts are individually replaceable.

PLEXIGLAS SOFT CLOSE CANINE DOG DOOR



Allows light in kennel the translucent panel allows a soft light into the kennel area.

Durable: Built heavy duty.

Opens: Dog bumps it open when exiting & uses the flange to nudge it open when entering.

Quiet: Lower the noise level and stress with a quiet closing door noise induced stress levels.

PLEXIGLAS DOG DOOR



The translucent panel allows a soft light into the kennel area.

Durable: Built heavy duty.

Opens: Dog bumps it open when exiting & uses the flange to nudge it open when entering.

Noise Level: We recommend adding a Kwiet Close (not included) to reduce noise induced stress levels

DELUXE DOG DOORS

with 2- Way Hinge



Easy Dog Door: Both directions just need a nudge.

Noise Level: We recommend adding a Kwiet Close (not included) to reduce noise induced stress levels

PET SAFE DOG DOOR



Allows Light In Kennel The translucent panel allows a soft light into the kennel area

Durable: Aluminum frame with flexible flap which is attached at the top

Opens: Dog nudges the flap which is secured in place with a magnetic strip at the bottom.

Noise Level: ?No noise

Replacement flaps available

ALUMINUM DOG DOOR



Solid aluminum panel does not allow light in kennel.

Durable: Built heavy duty.

Opens: Dog bumps it open when exiting & uses the flange to nudge it open when entering.

Noise Level: We recommend adding a Kwiet Close (not included) to reduce noise induced stress levels

ACCESSORIES



GUILLOTINE DOG DOOR MANUAL OPEN/CLOSE

If you need to lock your dogs in at night, or keep them out while cleaning, this is the door for you. Aluminum slides and door, uses a pulley with a metal cable and door snap latch to secure door at desired location.

The snap secures at front of kennel panel for easy access.



PLASTIC MOLDED DOG HOLE TRIM

Accommodates wall thickness anywhere from 3.5" to 6".

Available in white or weatherwood.



STAINLESS STEEL ADJUSTABLE TRIM KITS

Available in 2 wall thickness sizes: 4.5"-8.5" Wall, and 8.5"-10" Wall



EXTRA DEEP PLASTIC MOLDED ADJUSTABLE DOG HOLE TRIM

Accommodates wall thickness 3" - 12". Can be trimmed for depths less than 9.5".

Available in weatherwood only.

KWIET KLOSE

Cut the Noise and reduce the stress on your dogs! A great solution for keeping the whelping area quiet. Attaches to door trim and keeps dog doors from slamming.



TRAINER DOOR STOP

For use on deluxe and plexi door. Keeps the door ajar just a bit to help dog learn how to open door.



DOG DOOR LOCKS

Manually installs in door trim to allow you to lock your dogs in or out.



DOORS & WINDOWS



6-PANEL PRE-HUNG ENTRY DOOR

Gives you a draft free man door.



11-LITE WINDOW

Fixed Window - Compatible with the door shown above.



VENT WINDOW

Functional Window. Compatible with the door shown above.



9-LITE WINDOW

Fixed Window. Compatible with the door shown above.

ELECTRIC & LIGHTS



ELECTRICAL PACKAGE

- **1 Light**
 - **1 Receptacle**
 - **1 Light Switch**
 - **Electrical Box**
- More lights and receptacles can be added.



EXTERIOR ENTRANCE LIGHTS



EXTERIOR FLOOD LIGHTS DOUBLE BULB



24" X 36" SINGLE HUNG INSULATED

WEATHERVANES



BLACK EAGLE



BLACK ROOSTER



COPPER EAGLE



BOARD & BATTEN
WOOD WITH A
COPPER TOP

CUPOLAS



BLACK HORSE



COPPER STANDING
ROOSTER



COPPER HORSE



WHITE CUPOLA

AIR QUALITY



GABLE VENTS

Includes washable filter and 3.28 foot drain hose.



AIR CONDITIONER

Window Mounted.



16" ELECTRIC EXHAUST FAN W/ GABLE SHUTTERS

110V Exhaust Fan with aluminum gable shutters. 1900 CFM 1.35 Amps with Percentage Timer



ENVI HEATER

Wall Mounted.

FEEDING



3.5 QT. STAINLESS STEEL AUTO-WATER BOWL WITH FLOAT

Large Capacity!

Recommended for medium to large breeds. Bowl detaches from float in seconds by loosening two inset screws with a screwdriver. Includes hardware for wall mount or pole mount, and 12in. supply line hose.



STAINLESS STEEL 3 QT BOWL BRACKET

Use with chain-link or welded-wire kennel fronts. Keeps your food and water bowls secure while allowing you to remove them with ease, without opening the door.

Available in single or double.



ADJUSTABLE WATER NIBBLE BRACKET

Easily adjust your water nibble to a desired height. Includes 30" (above bracket) metal pipe with threads for connecting to supply line and to water nibble.



STAINLESS STEEL 3 QT BOWLS

Use with or without brackets.

AIR QUALITY CONT.



HEAT & AC UNIT

We Will Install the Recommended Size Unit According to the Square Footage of the Building.

Requires 220V / 20A Circuit



WASH DOWN



INTERIOR POLY COVER CHANNEL DRAIN

Our drains are placed right inside the dog door against the wall, from standing in feed isle. You can just wash everything back.

EXTERIOR OPTIONS



METAL ROOF
Standing Seam Metal Roof

EXTERIOR OPTIONS CONT.



METAL SIDING



VINYL SIDING



DELUXE TRIM PACKAGE

STANDARD PACKAGE



DORMERS

You Can Add A Dormer To Most Kennels



Z SHUTTERS



RAISED PANEL VINYL



SLAT SHUTTER

COLORS

Explore a spectrum of possibilities. Whether you're drawn to timeless whites, earthy tones, or vibrant accents, our extensive collection ensures you'll find the right shade. When inspiration strikes beyond our catalog, our custom color service brings your unique vision to life—formulated precisely to your personal or brand requirements

VINYL COLORS

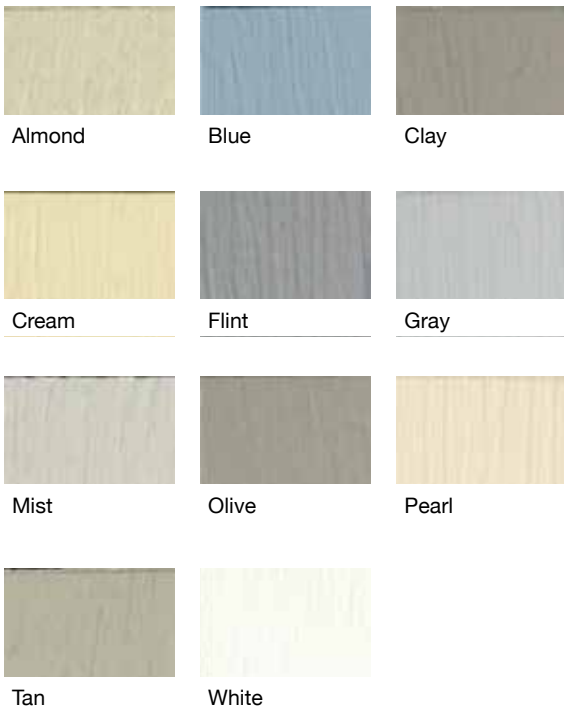

STAIN COLORS



METAL COLORS



Ash



Avocado



Barn Red



Beige



Black

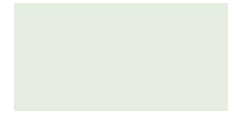

Bone White



Clay



Charcoal

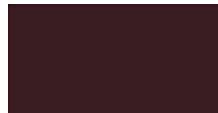

Burgundy

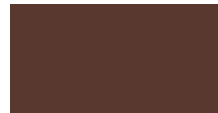

Brown

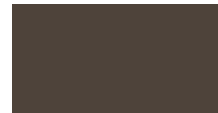

Bronze

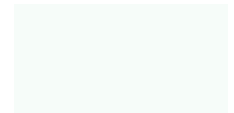

Bright White



Colonial Red



Dark Blue



Evergreen



Forest



Gallery Blue



Gold



Tan



Slate Blue



Scarlet



Pewter



Patina Green



Light Stone

PAINT COLORS



Avocado



Barn



Beige



Black Fox



Black



Buckskin



Dark Gray



Dark Brown



Dark Blue



Crabby Apple



Clay



Chestnut

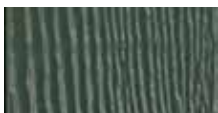

Green



Light Blue



Light Gray



Navajo



Roycroft Bronze



Summit Gray



White



Urbane Bronze



Taupe Tone

SHINGLE COLORS



Cedar



Charcoal



Forest



Nickel



Walnut



Cedar Shake
(Optional)



Weather Gray



Williamsburg Slate

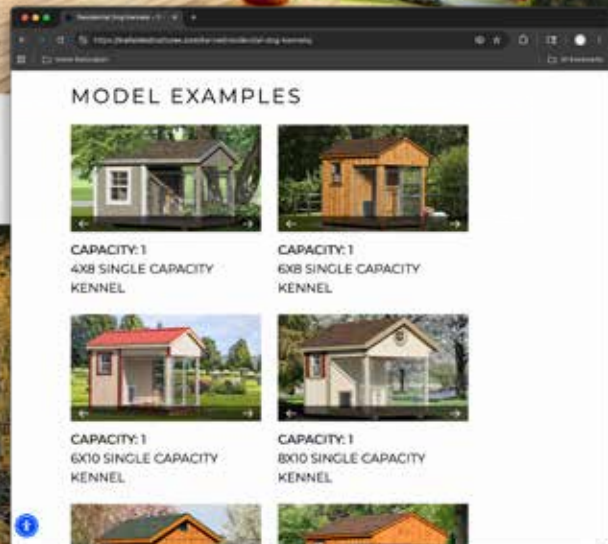
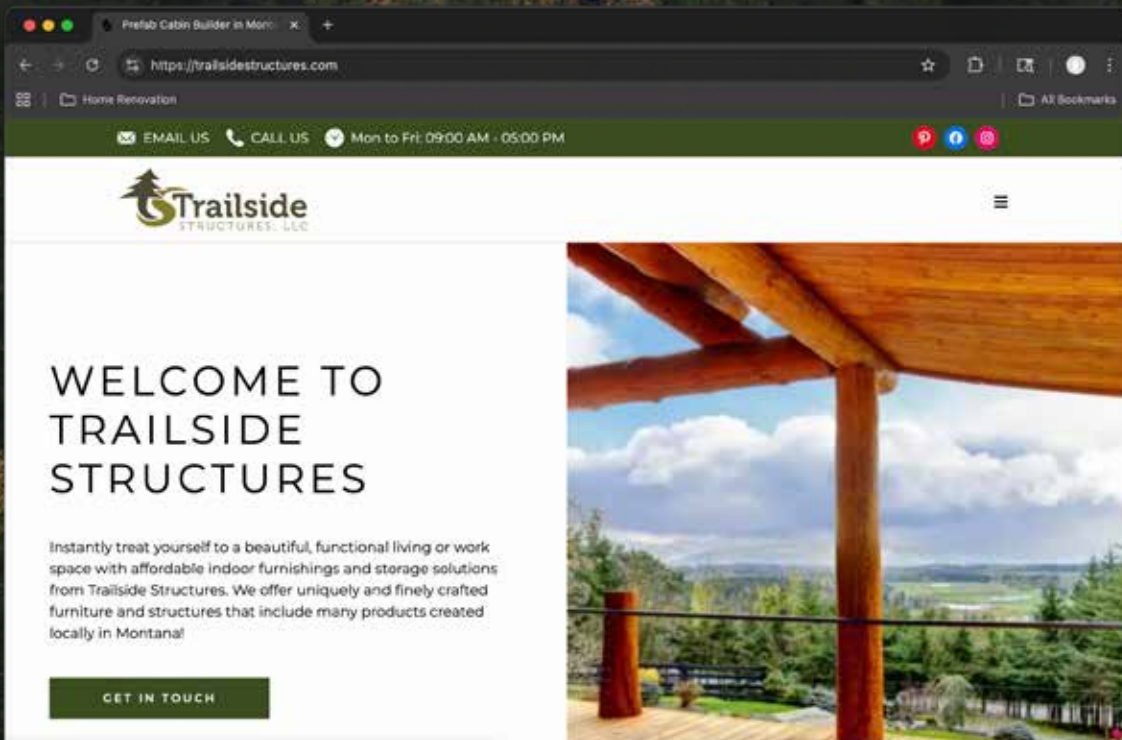

FOR MORE INFORMATION CHECK OUT OUR WEBSITE:

TRAILSIDESTRUCTURES.COM



1-800-655-5322
Sales@TrailsideStructures.com